



4, RIVERLIGHT QUAY
LONDON, SW11
Asking Price £900,000 Leasehold

Description

A two double bedroom, two bathroom apartment on the 10th floor of this impressive development in the heart of Nine Elms.

The property comprises approx.784sq.ft (72sq.m) of living space, with open plan living to the highest standards. There are full floor to ceiling windows accessing 2 private balconies and offering views of the River Thames and beyond. The apartment also has a smart custom designed fitted kitchen with Siemens appliances; there are 2 luxury bathrooms (1 En-suite) with Villeroy & Boch and Kaldewei sanitary ware, wood flooring and comfort cooling.

Riverlight features an exclusive residents Clubhouse with a sunlit atrium swimming pool and spa, a well-equipped mezzanine "river view" gymnasium, a reception lounge and library, as well as virtual golf, a cinema screening and digital games room, 24 hour concierge and a shuttle bus service to the transport links of Vauxhall, which are close by.

EPC B / Council Tax Wandsworth Band F

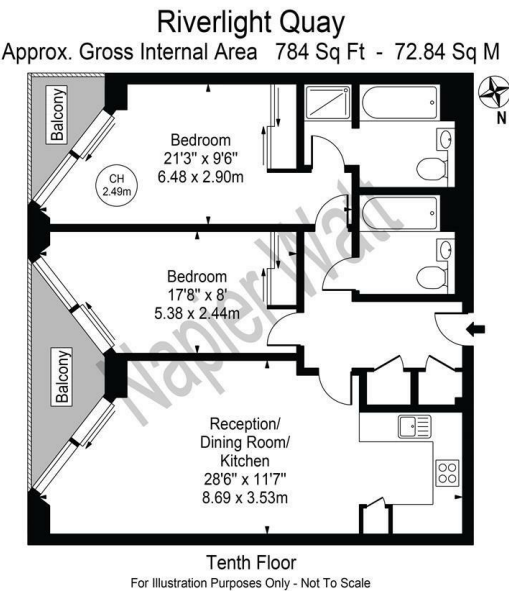

TERMS

Tenure: 999 years from 1 January 2012 ie 985 years
Ground Rent £700pw
Service Charge: £7493.44 PA.
Council Tax Wandsworth Band F
EPC B